

PIT LEVELER CURTAIN



Cover:

- 22oz. Vinyl
- Durable
- High chemical resistance
- Excellent weathering

Stays:

- Fiberglass laminate

DATE _____

END USER _____

ADDRESS _____

CITY _____

STATE _____

ZIP _____

REP _____

PIT LEVELER MODEL NO. _____

HYDRAULIC

MECHANICAL

LEVELER WIDTH _____

LEVELER HEIGHT _____

OF UNITS TO BE FITTED _____

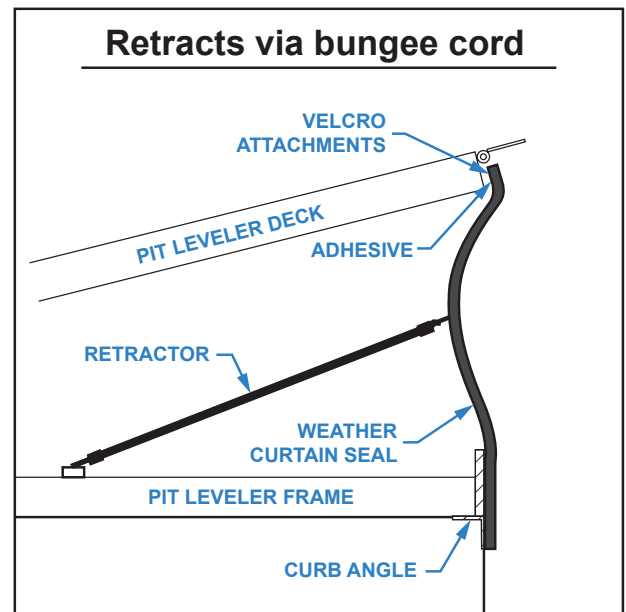

DANGER

IF ANY SAFETY LABELS WILL BE OBSTRUCTED BY PERMANENTLY AFFIXED COMPONENTS OF THE DOCK LEVELER CURTAIN, CONTACT THE ORIGINAL EQUIPMENT MANUFACTURER (OEM) TO OBTAIN REPLACEMENT SAFETY LABELS. INSTALL THE OEM SAFETY LABELS IN AN ADJACENT VISIBLE AREA.

PIT LEVELER CURTAIN

Step 1: Take a front view picture of the leveler in its open position.

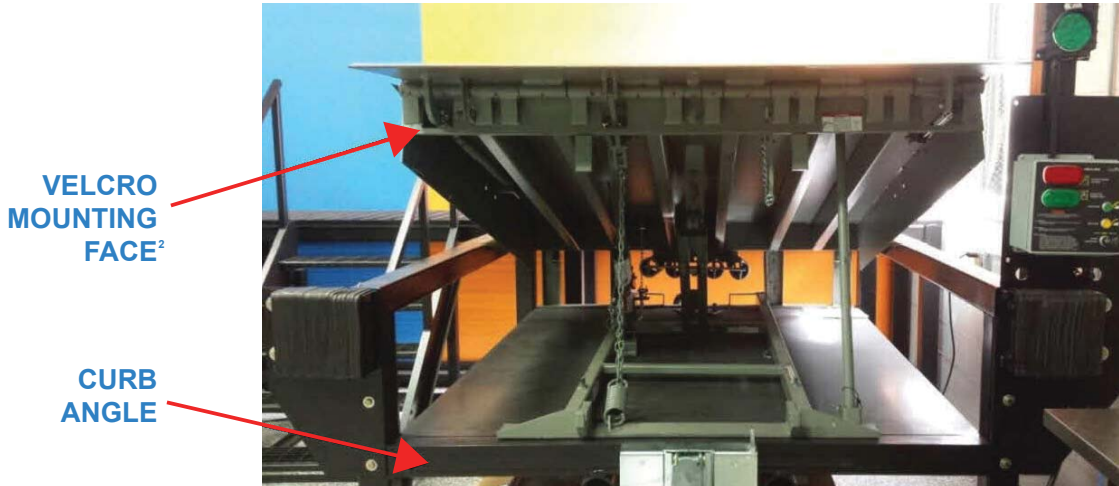

Step 2: Find the overall perimeter needed for mounting the curtain (black line this example). Overall width is measured between the pit walls.

Step 3: Determine all sections that need cutouts on the curtain (red lines in this example), including restraints, lip keepers, etc.

Step 4: Note the location of any dock leveler safety legs (green lines in this example) or other places requiring reinforcement patches (prolongs life).

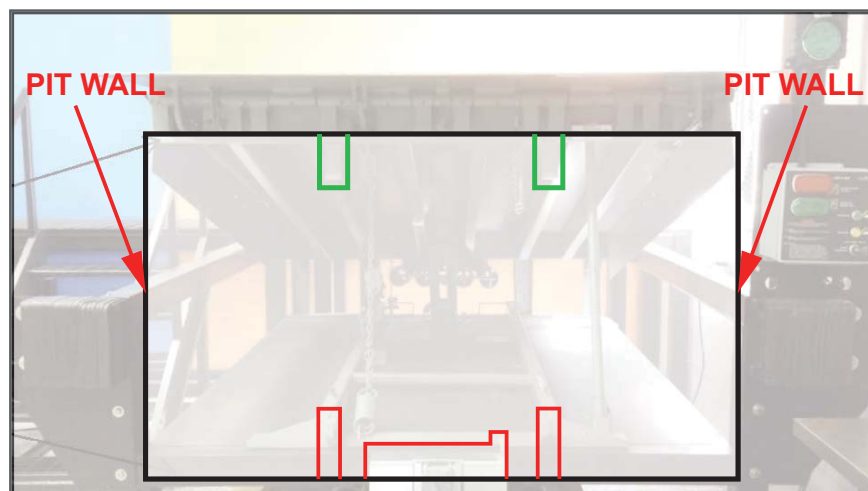

PIT LEVELER CURTAIN

Step 5: Inside the border box provided, draw any cutouts that are needed in the curtain (red lines in this example) and any reinforcement patches needed (green line in this example).

Step 6: going from left to right, write down all measurements between each feature (blue arrows with sample dimensions in this example). Measure in increments of 1/4”.

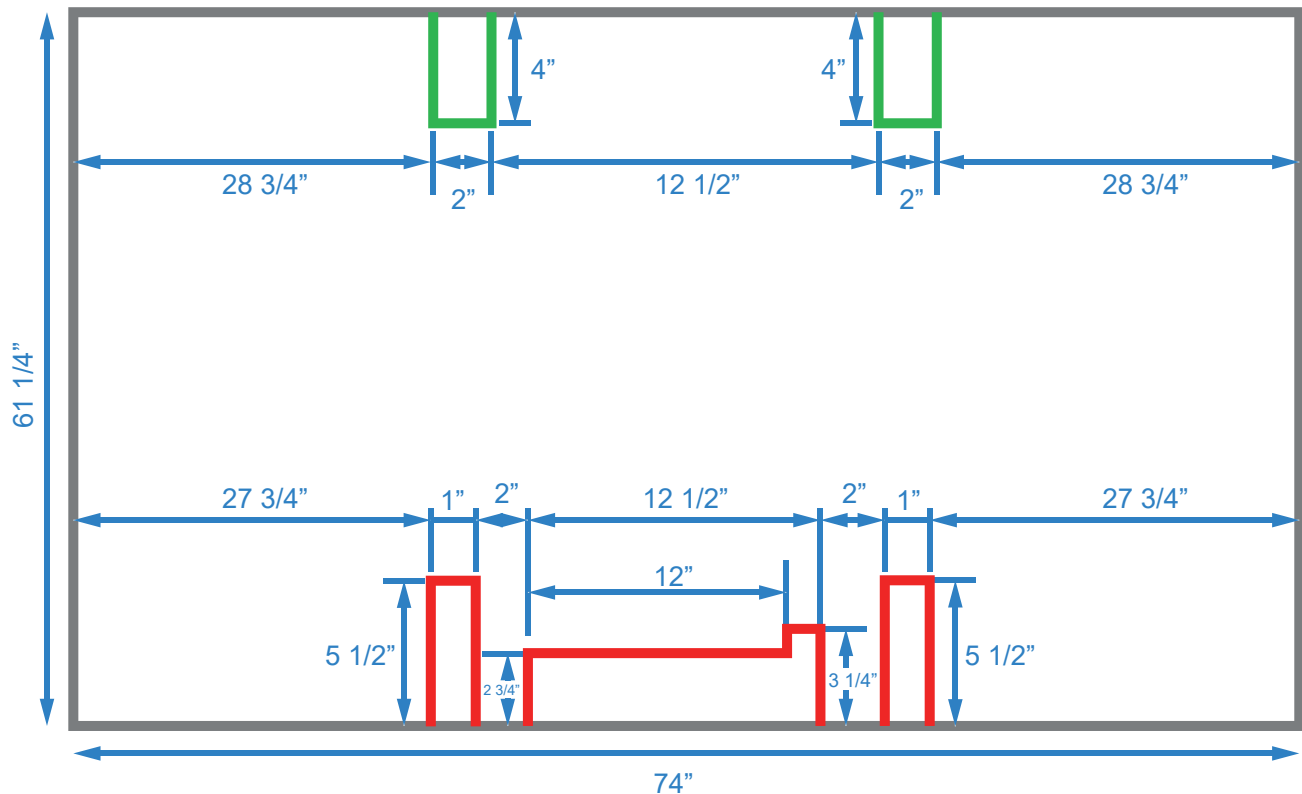

NOTES:

When the leveler opens, it may “over-extend” before settling in the open position. If possible, ensure the the overall height the leveler reaches is also provided.

Depending on the leveler, the mounting surface may be insufficient requiring an extra bar to be welded in place. Consult the Original Equipment Manufacturer (OEM) manual for such modifications.

PIT LEVELER CURTAIN



Please provide your photo with this survey, show the necessary cutouts, patches, and dimensions below.

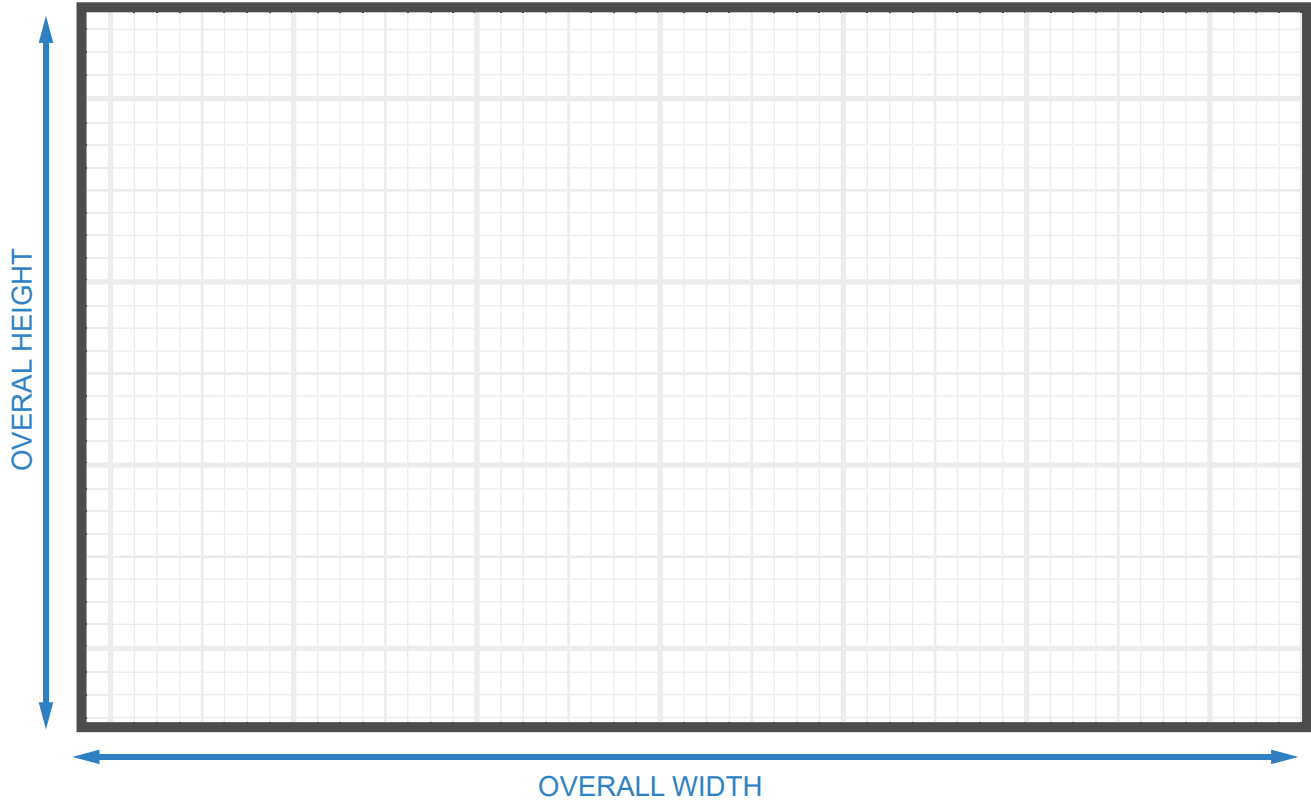

***Make note of the over-extension height if possible.**

Additional Notes:
